

INSULATED



INSULATED TOOLS



Anti Electro-Shock
Meets all requirements of THE VDE STANDARD
RELEVANT INTERNATIONAL STANDARDS. (IEC 60900)

INS

Insulated Torque Wrench Slip Type

TORQUE 3/8"

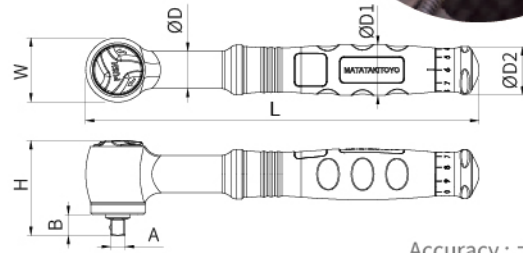
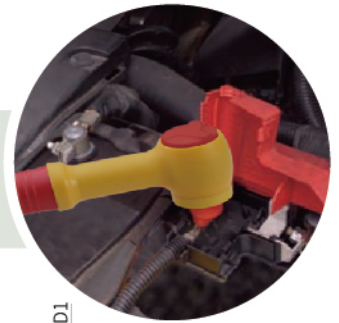

Specification

Accuracy : ±6%

ITEM NO.	A	Range		W	H	B	L	ØD	ØD1	ØD2	G	Packing
INS-25N	3/8"	5-25 Nm	0.05 Nm	44.7	65.7	11.6	269.3	25.6	35	33.9	695	12 pcs/CTN

Unit : mm

INS2

Insulated Torque Wrench Click Type

TORQUE 3/8" 1/2"

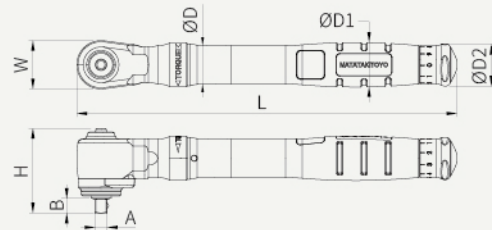

Specification

Accuracy : ±4%

ITEM NO.	A	Range		W	H	B	L	ØD	ØD1	ØD2	G	Packing
INS2-30N	3/8"	6~30 Nm	0.1 Nm	38.2	67.0	11.9	299.4	30	34.7	33.5	720	12 pcs/CTN
INS2-60N	3/8"	10~60 Nm	0.25 Nm	38.2	67.0	11.9	350.6	30	34.7	33.5	850	12 pcs/CTN
INS2-100N	3/8"	20~100 Nm	0.25 Nm	38.2	67.0	11.9	401.1	30	36.5	35.9	1050	12 pcs/CTN
INS2-200N	1/2"	40~200 Nm	1 Nm	50.0	82.1	13.6	447.0	32	36.5	35.9	N / A	12 pcs/CTN
INS2-300N	1/2"	60~300 Nm	2 Nm	50.0	82.1	13.6	576.0	32	36.5	35.9	N / A	12 pcs/CTN

Unit : mm

INS3

Insulated Torque Wrench Click Type

TORQUE 1/4" 3/8"

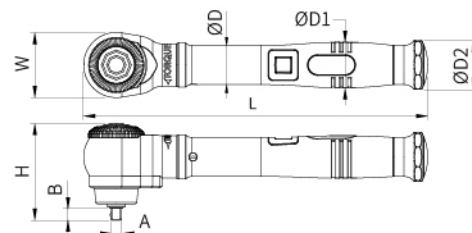

Specification

Accuracy : C.W. ±4%

ITEM NO.	A	Range	W	H	B	L	ØD	ØD1	ØD2	Packing
INS3-10N	1/4"	2-10 Nm	40	59	8.0	210.9	24	28	30	12 pcs/CTN
INS3-30N	3/8"	6-30 Nm	40	64	11.9	265.9	24	28	30	12 pcs/CTN

Unit : mm

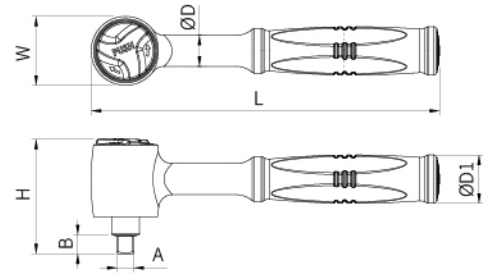
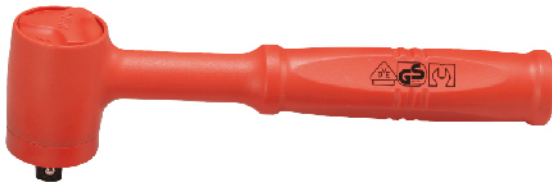
IR**Insulated Ratchet Handle****3/8" GEAR**

Specification

Unit : mm

ITEM NO.	A	Gear	W	H	B	L	ØD	ØD1	G	Packing
IR-38	3/8"	45	36	64	11	198	18	28	350	12 pcs/CTN

IE**Insulated Extensions****3/8"**

Specification

ITEM NO.	A	L		ØD	ØD1	G
		inch	mm			
IE-3806	3/8"	6.5	167	16.3	22.2	160
IE-3810	3/8"	10.5	268	16.3	22.2	260

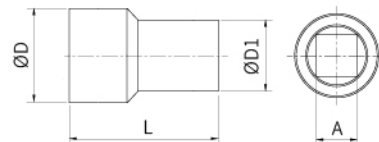
**IS****Insulated Sockets****3/8"**

Specification

ITEM NO.	Ø	A	L	ØD	ØD1	G
IS-3806	6	3/8"	43.0	14.7	22.4	28.0
IS-3807	7	3/8"	43.0	14.7	22.4	30.0
IS-3808	8	3/8"	43.0	17.0	22.4	30.0
IS-3809	9	3/8"	43.0	17.0	22.4	30.0
IS-3810	10	3/8"	43.0	19.4	22.4	30.0
IS-3811	11	3/8"	43.0	19.4	22.4	30.0
IS-3812	12	3/8"	44.3	21.3	22.4	30.0

Specification

ITEM NO.	Ø	A	L	ØD	ØD1	G
IS-3813	13	3/8"	44.3	21.3	22.4	31.0
IS-3814	14	3/8"	44.3	25.3	22.4	38.5
IS-3815	15	3/8"	44.3	25.3	22.4	47.0
IS-3816	16	3/8"	46.4	25.3	22.2	47.0
IS-3817	17	3/8"	46.4	29.2	22.2	54.0
IS-3818	18	3/8"	46.4	29.2	22.2	58.0
IS-3819	19	3/8"	46.4	29.2	22.2	61.0

Unit : mm