

Interchangeable Head Torque Handle Pre-Set Type OPERATION MANUAL

Models covered

CPS

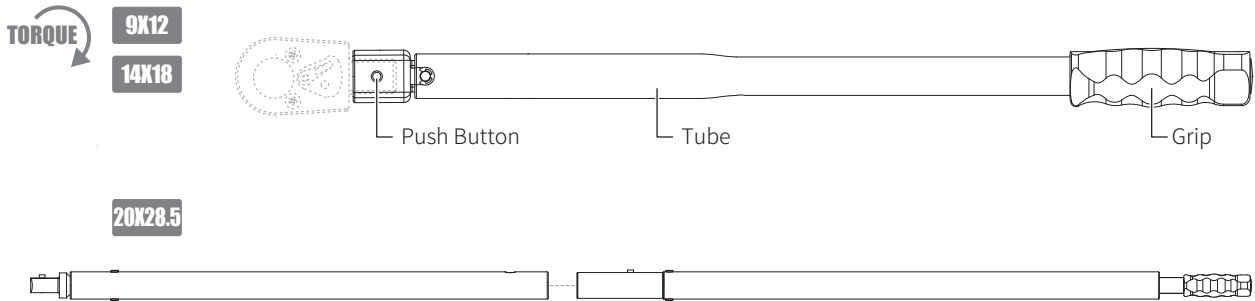

BEFORE STARTING

1. Study this instruction before use.
2. This torque wrench as calibrated and tested before leaving the factory is certified to meet the current standard specification and has an accuracy of $\pm 4\%$.
3. **THIS TOOL IS A PRECISION MEASUREMENT AND DESIGNED FOR MANUAL TIGHTENING FASTENERS ONLY. DO NOT USE IT AS A NUT BREAKER OR FOR ANY OTHER PURPOSE.**
4. Over torque will cause tool damage and personal injury.
5. Do not use this tool near rotating machinery.
6. Disassemble this tool or make any adjustments will result of losing accuracy and void the warranty.
7. Do not continuously apply force after hear click or feel shock.
8. Do not use any format of extension on the handle of the tool.
This will not only damage the tool, also affect the accuracy.
9. Use special care at minimum torque setting.
10. Please wear gloves and goggles when working.

CONTENTS

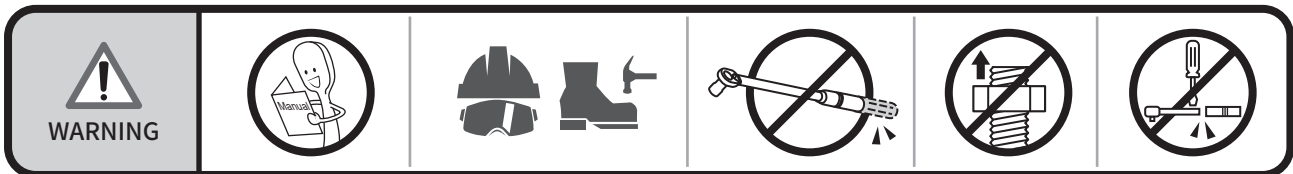
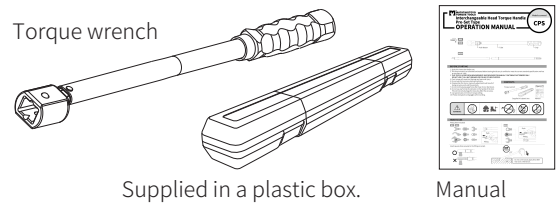

HOW TO USE

Fitting (Not included)

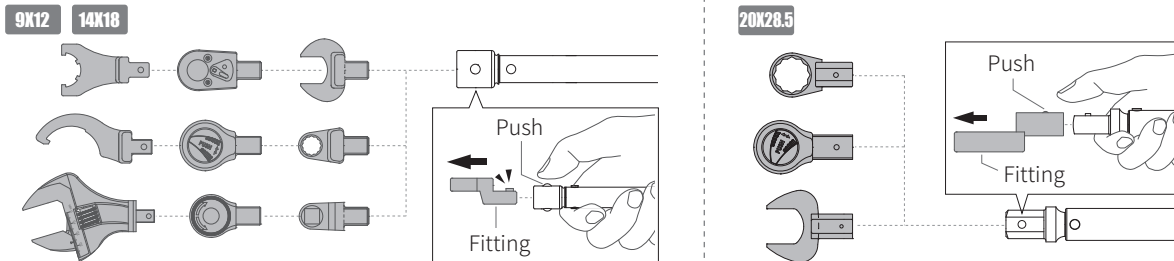

Insert square drive securely to the fitting or socket.

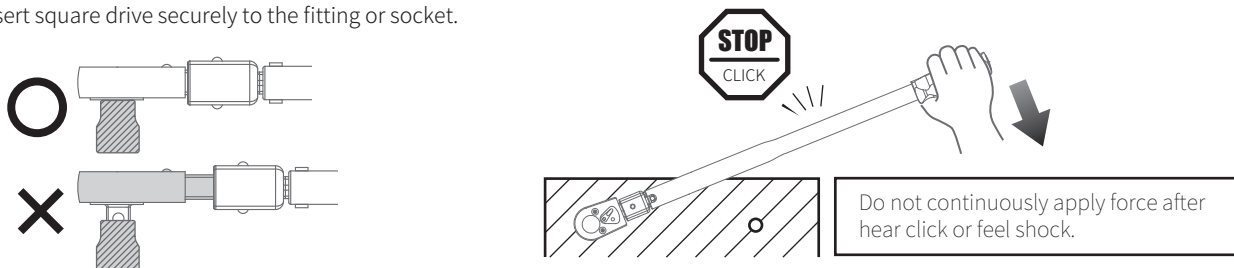

MAINTENANCE AND STORAGE

1. If this tool has not been used for a period of time, it shall be preloaded several times to allow internal lubricant to recoat.
2. Clean this tool by wiping with a clean cloth after operation and storage in a dry environment.
Do not dip any type of liquid in this tool. This may damage the internal of this tool.
3. This tool should be recalibrated a period of 12 months, or 5,000 cycles, whichever occurs first.
To contact with local vendor, an authorized repair center for supporting.

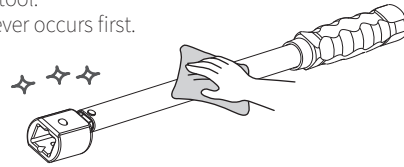

TORQUE CONVERSION FACTORS

| Units to be converted | Corresponding unit | | | | | | | | |
|-----------------------|--------------------|-------|--------|---------|---------|---------|--------|-----------------|---------------|
| | =mN-m | =cN-m | =N-m | =ozf-in | =lbf-in | =lbf-ft | =gf-cm | =kgf-cm (kp-cm) | =kgf-m (kp-m) |
| 1 mN-m | 1 | 0.1 | 0.001 | 0.142 | 0.009 | 0.0007 | 10.2 | 0.01 | 0.0001 |
| 1 cN-m | 10 | 1 | 0.01 | 1.416 | 0.088 | 0.007 | 102 | 0.102 | 0.001 |
| 1 N-m | 1000 | 100 | 1 | 141.6 | 8.851 | 0.738 | 10197 | 10.2 | 0.102 |
| 1 ozf-in | 7.062 | 0.706 | 0.007 | 1 | 0.0625 | 0.005 | 72 | 0.072 | 0.0007 |
| 1 lbf-in | 113 | 11.3 | 0.113 | 16 | 1 | 0.083 | 1152.1 | 1.152 | 0.0115 |
| 1 lbf-ft | 1356 | 135.6 | 1.356 | 192 | 12 | 1 | 13826 | 13.83 | 0.138 |
| 1 gf-cm | 0.098 | 0.01 | 0.0001 | 0.014 | 0.0009 | 0.00007 | 1 | 0.001 | 0.00001 |
| 1 kgf-cm(kp-cm) | 98.07 | 9.807 | 0.098 | 13.89 | 0.868 | 0.072 | 1000 | 1 | 0.01 |
| 1 kgf-m(kp-m) | 9807 | 980.7 | 0.9807 | 1389 | 86.8 | 0.723 | 100000 | 100 | 1 |

Conversion-formula :

Units to be converted × Factor = Corresponding unit

Example : Convert 5 lbf-ft into cN-m

Solution : 5 × 135.6 = 678 cN-m

SPECIFICATION

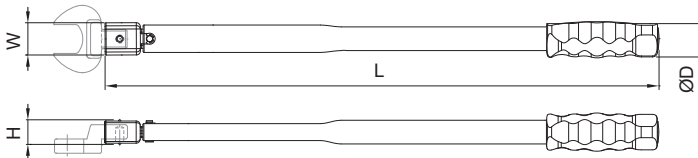

Metric

| ITEM NO. | | Range | W | H | L | ØD | KG |
|-----------|---------|-------------|------|------|------|------|-------|
| CPS-12N | 9x12 | 2-12 Nm | 23.8 | 16.7 | 188 | 27.4 | 0.22 |
| CPS-50N | 9x12 | 10-50 Nm | 24.0 | 16.2 | 290 | 37.3 | 0.51 |
| CPS-50NS | 14x18 | 10-50 Nm | 24.0 | 16.2 | 290 | 37.3 | 0.51 |
| CPS-100N | 9x12 | 20-100 Nm | 23.9 | 16.2 | 420 | 37.3 | 0.69 |
| CPS-100NS | 14x18 | 20-100 Nm | 23.9 | 16.2 | 420 | 37.3 | 0.69 |
| CPS-200N | 14x18 | 50-200 Nm | 32.1 | 23.2 | 500 | 37.3 | 1.25 |
| CPS-300N | 14x18 | 80-300 Nm | 32.3 | 24.7 | 580 | 37.3 | 3.55 |
| CPS-500N | 14x18 | 100-500 Nm | 33.1 | 27.0 | 738 | 37.3 | 5.80 |
| ITEM NO. | | Range | W | H | L | ØD | KG |
| CPS-800N | 20x28.5 | 150-800 Nm | 28.0 | 24.0 | 961 | 37.3 | 6.30 |
| CPS-1200N | 20x28.5 | 240-1200 Nm | 28.0 | 24.0 | 1381 | 37.3 | 8.80 |
| CPS-1500N | 20x28.5 | 300-1500 Nm | 28.0 | 24.0 | 1787 | 37.3 | 11.45 |

SAE

Accuracy: ± 4%

| ITEM NO. | | Range | W | H | L | ØD | KG |
|-----------|---------|----------------|------|------|------|-------|-------|
| CPS-120i | 9x12 | 20-120 in.lb | 23.8 | 16.7 | 188 | 20.70 | 0.22 |
| CPS-40F | 9x12 | 4-40 ft.lb | 24.0 | 16.2 | 290 | 30.80 | 0.51 |
| CPS-40FS | 14x18 | 4-40 ft.lb | 24.0 | 16.2 | 290 | 30.80 | 0.51 |
| CPS-80F | 9x12 | 10-80 ft.lb | 23.9 | 16.2 | 420 | 30.80 | 0.69 |
| CPS-80FS | 14x18 | 10-80 ft.lb | 23.9 | 16.2 | 420 | 30.80 | 0.69 |
| CPS-150F | 14x18 | 40-150 ft.lb | 32.1 | 23.2 | 500 | 34.00 | 1.25 |
| CPS-230F | 14x18 | 60-230 ft.lb | 32.3 | 24.7 | 580 | 40.00 | 3.55 |
| CPS-400F | 14x18 | 80-400 ft.lb | 33.1 | 27.0 | 738 | 37.85 | 5.80 |
| ITEM NO. | | Range | W | H | L | ØD | KG |
| CPS-600F | 20x28.5 | 120-600 ft.lb | 28.0 | 24.0 | 961 | 37.20 | 6.30 |
| CPS-800F | 20x28.5 | 150-800 ft.lb | 28.0 | 24.0 | 1381 | 37.40 | 8.80 |
| CPS-1000F | 20x28.5 | 200-1000 ft.lb | 28.0 | 24.0 | 1787 | 37.40 | 11.45 |

Unit: mm

Edition 01

MAY 2020



MATATAKITOYO
TORQUE TOOLS
E-mail: matatakitoyo@gmail.com
www.matatakitoyo.com

Manufacturer

MATATAKITOYO TOOL CO., LTD.

No. 63, Ln. 493, Sec. 3, Zhongshan Rd., Tanzi Dist.,

Taichung City 42754, Taiwan

TEL : 886-4-2533 5893

Made in Taiwan