

Interchangeable Head Adjustable Torque Handle Window Scale Type OPERATION MANUAL

TORQUE **9X12** **14X18** **20X28.5**

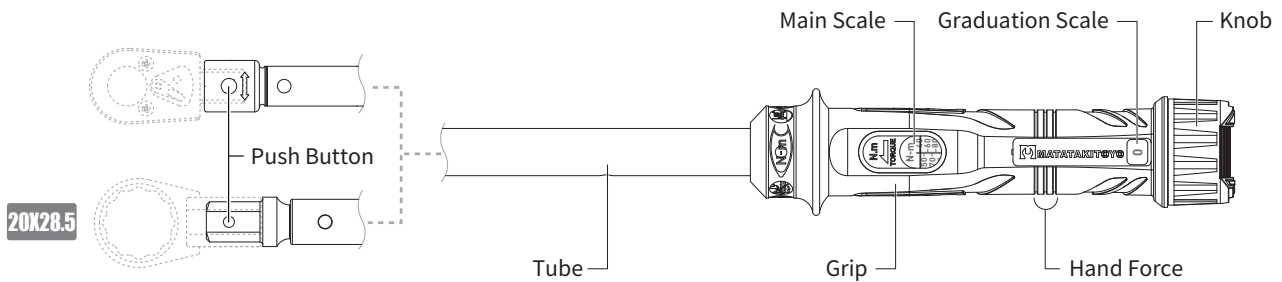

BEFORE STARTING

1. Study this instruction before use.
2. This torque wrench is calibrated and tested before leaving the factory, it is certified to meet the current standard specification and has an accuracy of $\pm 4\%$.
3. **THIS TOOL IS A PRECISION MEASUREMENT AND DESIGNED FOR MANUAL TIGHTENING FASTENERS ONLY. DO NOT USE IT AS A NUT BREAKER OR FOR ANY OTHER PURPOSE.**
4. Do not over torquing the fastener, or it will cause tool's damage and serious injury.
5. Do not use this tool near rotating machinery.
6. Disassemble this tool or make any adjustments will result in the loss of accuracy and invalidating the warranty.
7. Do not continuously apply force after hearing the clicking sound or feel shock.
8. Do not use any kind of extension on the handle of the tool. This will not only damage the tool, also affect the accuracy.
9. Do not immerse grease inside ratchet head. It may cause unexpected damage.
10. Use special care at minimum torque setting.
11. Please wear gloves and goggles when working.

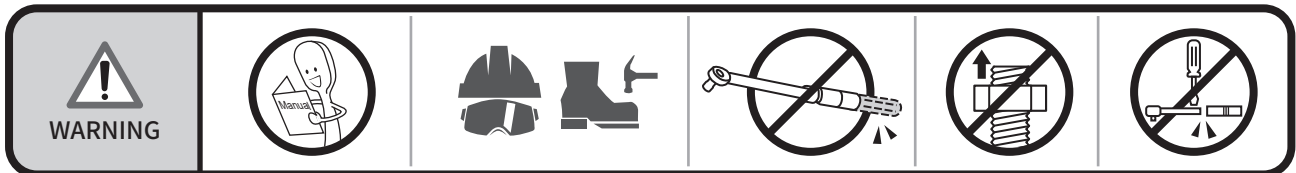

操作説明

CONTENTS

Fitting (Not included)

9X12 **14X18**

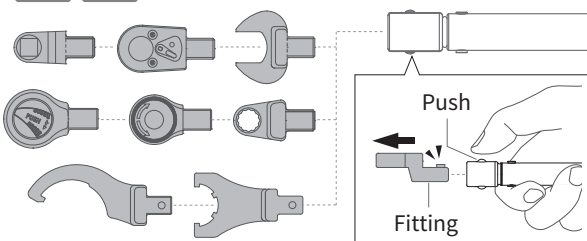

20X28.5

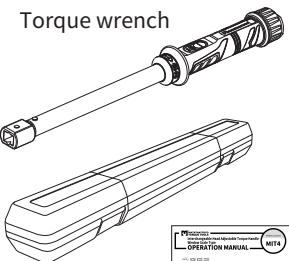
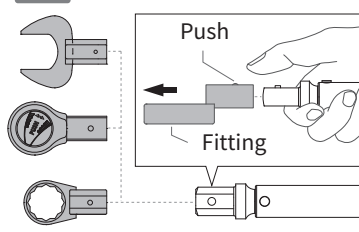

Insert square drive securely to the fitting or socket.

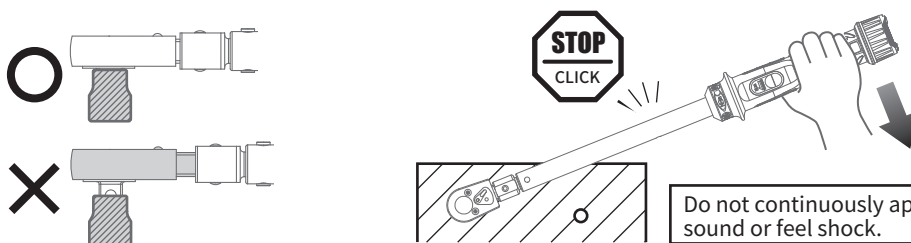

HOW TO SET TORQUE VALUE

1. Cut the push button to OPEN.
2. Turn the knob Clockwise or Anti-clockwise (Right or left) to set the desired torque.
3. Then push the push button to LOCK to complete the setting.

For example : ITEM NO. MIT4-200N

To set torque to 135 Nm. Red line of main scale need to reach 130 Nm (See A) and adjust graduation scale to 5 Nm (See B). Then 130+5=135Nm (See C)

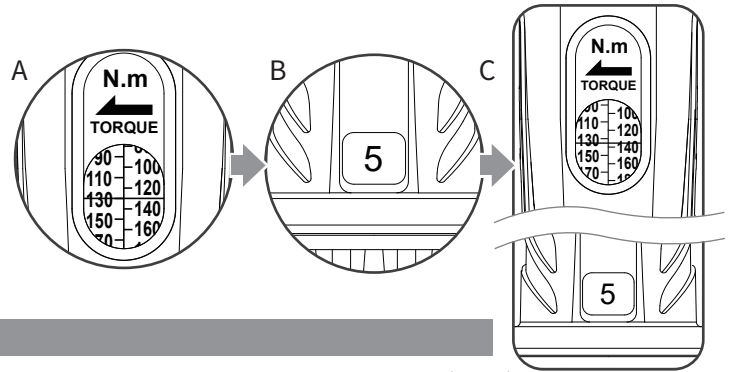
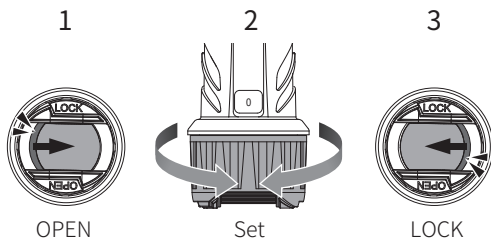

MAINTENANCE AND STORAGE

1. Please return torque value to just below lowest reading when not in use. Do not turn below lowest reading. (See D)
2. If this tool has not been used for a period of time, it shall be preloaded several times at its maximum torque setting. This will allow internal lubricant to recoat.
3. Clean this tool by wiping with a clean cloth after operation and storage in a dry environment. Do not dip any type of liquid in this tool. This may damage the internal of this tool.
4. This tool should be recalibrated a period of 12 months, or 5,000 cycles, whichever occurs first. To contact with local vendor or an authorized repair center for supporting.

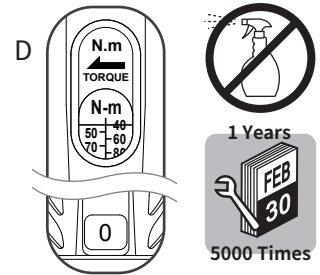

TORQUE CONVERSION FACTORS

Units to be converted	Corresponding unit								
	=mN-m	=cN-m	=N-m	=ozf-in	=lbf-in	=lbf-ft	=gf-cm	=kgf-cm (kp-cm)	=kgf-m (kp-m)
1 mN-m	1	0.1	0.001	0.142	0.009	0.0007	10.2	0.01	0.0001
1 cN-m	10	1	0.01	1.416	0.088	0.007	102	0.102	0.001
1 N-m	1000	100	1	141.6	8.851	0.738	10197	10.2	0.102
1 ozf-in	7.062	0.706	0.007	1	0.0625	0.005	72	0.072	0.0007
1 lbf-in	113	11.3	0.113	16	1	0.083	1152.1	1.152	0.0115
1 lbf-ft	1356	135.6	1.356	192	12	1	13826	13.83	0.138
1 gf-cm	0.098	0.01	0.0001	0.014	0.0009	0.00007	1	0.001	0.00001
1 kgf-cm(kp-cm)	98.07	9.807	0.098	13.89	0.868	0.072	1000	1	0.01
1 kgf-m(kp-m)	9807	980.7	0.9807	1389	86.8	0.723	100000	100	1

Conversion-formula :

Units to be converted × Factor = Corresponding unit

Example : Convert 5 lbf-ft into cN-m

Solution : 5 × 135.6 = 678 cN-m

SPECIFICATION

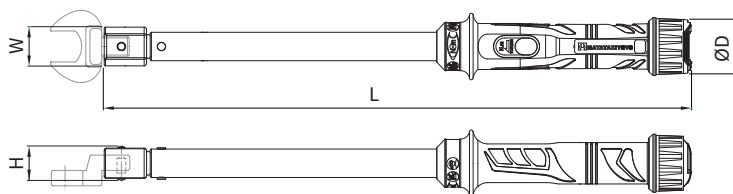

Metric

ITEM NO.	Range	Resolution	W	H	L	ØD	KG
MIT4-60N	12-60 Nm	0.5 Nm	22.2	19.2	367	44.5	1.00
MIT4-100N	20-100 Nm	0.5 Nm	22.2	19.2	407	44.5	1.05
MIT4-200N	40-200 Nm	1 Nm	32.0	25.0	488	44.5	1.34
MIT4-320N	60-320 Nm	2 Nm	32.0	25.0	554	44.5	1.70
MIT4-500N	100-500 Nm	2.5 Nm	32.0	25.0	770	44.5	3.28
MIT4-1000N	200-1000 Nm	5 Nm	28.5	20.1	1230	44.5	5.50

SAE

ITEM NO.	Range	Resolution	W	H	L	ØD	KG
MIT4-45F	9-45 ft.lb	0.25 ft.lb	22.2	19.2	367	44.5	1.00
MIT4-75F	15-75 ft.lb	0.5 ft.lb	22.2	19.2	407	44.5	1.05
MIT4-150F	30-150 ft.lb	0.5 ft.lb	32.0	25.0	488	44.5	1.34
MIT4-250F	50-250 ft.lb	1 ft.lb	32.0	25.0	554	44.5	1.70
MIT4-300F	60-300 ft.lb	2.5 ft.lb	32.0	25.0	770	44.5	3.28
MIT4-700F	100-700 ft.lb	5 ft.lb	28.5	20.1	1230	44.5	5.50

Accuracy : ± 4%

Unit : mm

Version 02

Jan. 2023



MATATAKITOYO
TORQUE TOOLS

E-mail: matatakitoyo@gmail.com
www.matatakitoyo.com

Manufacturer

MATATAKITOYO TOOL CO., LTD.

No. 63, Ln. 493, Sec. 3, Zhongshan Rd., Tanzi Dist.,
Taichung City 42754, Taiwan
TEL : 886-4-2533 5893

Made in Taiwan